

Leigh Park



Community Centre

HISTORY

Leigh Park Community Centre was built under a section 106 agreement between Wiltshire Council and Persimmon Homes formed in 1999. The keys were handed to the Charity “Leigh Park Community Centre (Westbury)” on 29th November 2012 and was opened to the public on 7th January 2013.

CHARITY STATUS

The LPCC became a registered charity on 16th November 2015 with a Charity Incorporated Organisation (CIO) Constitution.

FOUNDATION

Recognising the diversity of community needs and the challenges our society faces, Leigh Park Community Centre is dedicated to bringing the community together through a range of community events, flexible regular activities and sessions delivered by local businesses.

Our activities are designed to enhance the quality of life to existing local residents by encouraging and promoting social unity and allow us to generate additional funds for reuse in the local community.

WHAT WE OFFER

Having such versatile premises has allowed us to adapt our hire venue premises to the need of the community. Outside of hall hire, our business also offers:

The Lounge Coffee Shop

Open to the public Monday to Friday 9am to 3pm.

We hope as business grows to also open
Saturdays and for longer opening hours



White Horse Preschool

Funded and private sessions available

Monday to Friday 9am to 3pm,
term time only for 2-5 year olds



FUTURE DEVELOPMENT

As part of our land transfer we were also awarded the additional land adjacent to the community centre. Our future development plans of The Leigh Park Community Campus are designed to be all inclusive, community orientated and aimed at providing extended services to the local and wider community.

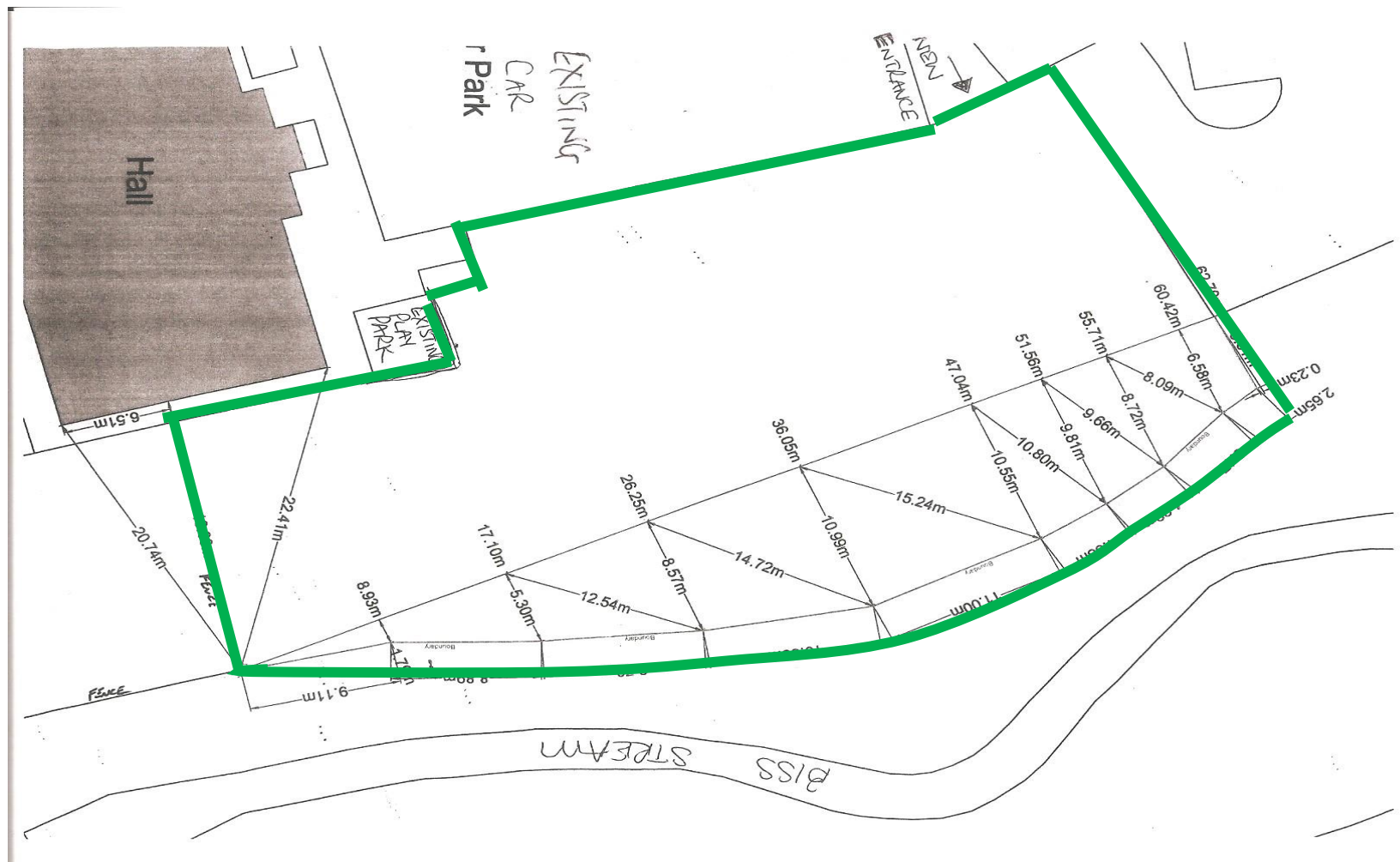



Aerial view of
**Leigh Park
Community Centre**

Including
Overflow Car Park
&
Additional Land

Additional Land Project Ideas



Community Shop – Westbury’s first environmentally friendly / zero waste shop!

A large shop supplying loose produce sourced locally (supporting local businesses) A zero waste shop selling a wide selection of foods, herbs, oils and cleaning equipment without the plastic and additional packaging.



Office Pods – Furnished office space to hire, all-inclusive pricing, long term let or hire by the hour

For small local business to hire as and when for small office space, meetings, interviews, staff training, mediation etc



Education & Teaching Centre – An extension to the learning environment for schools and businesses

An outreach centre for use by local schools and businesses, the facility would also be suitable for blood donations, diabetes classes, mammograms, community related nursing such as leg clinic, mental health awareness, pop up library, cooking workshops, gardening courses, credit union etc



Health Outreach – A tranquil space, modern and contemporary for hire by the hour, day or long term let

For local business to hire for holistic therapies such as massage, reflexology, one to one sessions such as yoga & Pilates, meditation, hypnotherapy, community related nursing etc



Community Garden – A peaceful community-initiated garden for all to enjoy and to provide a meeting point

A fully accessible community garden including sensory area, flower displays, water features, produce corner to supply zero waste shop.



Shop Share – Rent a shelf on a monthly basis

An area for local homebased businesses to display their homemade items, crafts and seasonal wares etc. A great way to engage local people into networking and supporting each other and the community

Plans are now underway to develop the business plan of the adjacent land, and this is where our Joint Public Consultation comes in, it will help us understand better what the community needs are.



We have discussed our project plans with:

Wiltshire Council - Westbury Town Council - Westbury Area Board

Westbury Community Engagement Manager - Local Area Co-Ordinator at Wiltshire Council

Social Subscribers at White Horse Surgery - Community First

If you have any further suggestions or would like to get involved please email
office@lpccwestbury.org.uk